



Automatic Connector Application Machine (ACAM™)

- Wire-Nut® Wire Connectors installed at lowest cost
- Automatically feeds and positions connectors for fast application
- Precise torque control ensures consistent reliable splices
- Simple control allows operator to adjust torque
- Bulk-fed connectors reduces fill time
- Adaptable to both assembly line and work cell environments





Wire-Nut® Wire Connectors

- Fixed, square-wire spring creates its own threads – maintains a secure positive grip that will not relax over time
- Tapered entry smoothly funnels wires into the connector and reduces the risk of turned back strands
- Positive grip design provides fast, easy installation with no pre-twist required
- High-tensile spring design increases mechanical holding power and provides lowest resistance splice
- Welded one-piece spring and shell construction prevents separation.
- Reusable for easy circuit changes and additions
- Tough, UL94V-2 flame-retardant shell will not crack or break. Rated to 105°C (221°F)



High Temperature



- Specially designed to withstand the extreme heat build-up commonly found in high wattage light fixtures and signs
- Rated to 150°C (302°C)



Cu/Cu Only



EN 60-998-2-4

Model	Wire Combination Range	Quantity	105°C Cat. No.	150°C Cat. No.
71B® Gray/ Black	300V 22 to 16 AWG Min. 2 #22 - Max. 2 #16	1,000/carton	30-171	30-151
		25,000/keg	30-271	30-251
		150,000/keg	30-871	–
72B® Blue/ Black	300V 22 to 14 AWG Min. 2 #22 - Max. 3 #16	1,000/carton	30-172	30-152
		10,000/keg	30-272	30-252
		85,000/keg	30-872	–
73B® Orange/ Black	600V* 22 to 14 AWG Min. 1 #18 & 1 #20 Max. 4 #16 & 1 #20	1,000/carton	30-173	30-153
		10,000/keg (20 bags, 500 ea.)	30-273	–
		10,000/keg	30-673	30-253
		50,000/keg	30-873	–
74B® Yellow/ Black	600V* No. 18 to 12 AWG Min. 2 No. 18 Max. 3 No. 14 & 1 No. 18	1,000/carton	30-174	–
		10,000/keg (20 bags, 500 ea.)	30-274	–
		10,000/keg	30-674	–
		35,000/keg	30-874	–
76B® Red	600V* No. 18 to 10 AWG Min. 2 No. 14 Max. 2 No. 10 & 2 No. 12	1,000/carton	30-176	–
		5,000/keg (20 bags, 250 ea.)	30-276	–
		15,000/keg	30-876	–
59B™ Black	600V* 22 to 12 AWG Min. 2 #20 Max. 3 #14	1,000/carton	–	30-153
		5,000/keg	–	30-259

ACAM Specifications

- Can be used on 110V or 220V power supplies
- ACAM unit - 60 lbs., Stand weight - 87 lbs.
- Adjustable torque range - 256 levels of adjustment with a 7 in. lbs. maximum
- Wire range - 22 to 8 AWG
- Option bench mount handgun holder and foot switch
- Cycle time - 1.5 seconds*
- Average operator production speeds - 600 splices per hour*

*Note: Cycle time and operator production speed can vary depending upon torque setting and difficulty of wire combinations

ACAM Connector Model No.	ACAM Cat. No.
71	30-971
72	30-972
73	30-973
74	30-974
59	30-959

Optional Accessories

Description	Cat. No.
Adjustable Mounting Stand	2-9053
Bench Mount and Foot Switch	30-984
Auxiliary Hopper	30-951

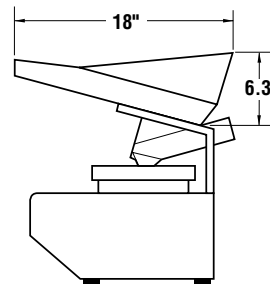

ACAM AUXILIARY HOPPER

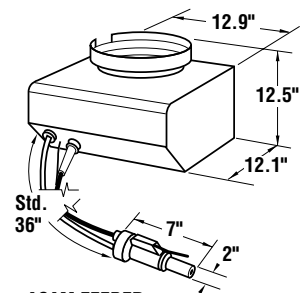

ACAM FEEDER MECHANISM, HANDGUN AND TOOL BALANCER

IDEAL INDUSTRIES, INC.

Becker Place, Sycamore, IL 60178, USA / 815-895-5181 • 800-324-9571 in USA

International offices:

Australia • Brazil • Canada • China • Germany • Mexico • UK

For complete sales office contact information, visit us at:

www.idealindustries.com